



SMART CAREGIVER CORPORATION

SMART

Basic Fall Monitor

- Adjustable Volume
- Safety Auto-Reset

Installation and Use Instructions

Basic Fall Monitor

CAUTION: The manufacturer does not claim that this device will prevent falls and/or elopement. Sensor pads and fall monitors are prone to difficulties. Be sure cord cannot entangle or choke the user. Test this device before each use. This device is designed to augment caregivers' comprehensive resident mobility management program and is not a substitute for proper nursing care. The effectiveness of this monitoring device relies entirely on the direct supervision and immediate response by the caregiver to this monitor's alarm. Failure to comply with this warning may result in injury or death. READ THE INSTRUCTIONS AND LEGAL DISCLAIMER.

Warning: FAILURE TO COMPLY WITH WARNING MAY RESULT IN INJURY OR DEATH. This device is not suitable for all individuals. Other devices may be required. This device is not a substitute for visual monitoring by caregiver. The manufacturer does not claim that this device will stop elopement and/or stop falls. This device is designed to augment caregivers' existing comprehensive resident mobility management program. **Test this device before each use. Read the instructions and Legal Disclaimer before each use.**

This Pad and Fall Monitor System is designed to be installed by the end-user. As such, it is the entire responsibility of the buyer to ensure that the system is properly installed and tested. Further, the system is not designed to replace good caregiving practices including, but not limited to:

- Direct patient supervision
- Adequate training for staff personnel for resident fall management and elopement
- Testing of the system before each use

WHERE PERMISSIBLE, IT IS THE SELLER'S INTENT TO LIMIT ANY LIABILITY FOR SPECIAL, CONSEQUENTIAL OR INCIDENTAL ECONOMIC DAMAGES TO REFUND OF THE PURCHASE PRICE OR REPLACEMENT OF THE GOODS. SELLER DISCLAIMS ANY LIABILITY FOR COMPENSATORY OR OTHER DAMAGES ARISING OUT OF THE USE OF THE GOODS.

Limited warranty

Seller warrants that the goods sold will be free from defects of workmanship and manufacturing, for a period of one year from the date of sale. Other than this limited warranty, seller makes no express or implied warranties. Except for this limited warranty, NO EXPRESS OR IMPLIED WARRANTIES ARE GIVEN AND NO AFFIRMATION OF SELLER, BY WORDS OR ACTION, WILL CONSTITUTE A WARRANTY. THE GOODS BEING PURCHASED ARE BEING SOLD ON A "WITH ALL FAULTS" BASIS. THE ENTIRE RISK AS TO THE QUALITY AND PERFORMANCE OF THE GOODS IS WITH THE BUYER. SHOULD THE GOODS PROVE DEFECTIVE FOLLOWING THEIR PURCHASE, THE BUYER, AND NOT THE MANUFACTURER, DISTRIBUTOR, OR RETAILER, ASSUMES THE ENTIRE COST OF ALL NECESSARY INSTALLATION, SERVICING OR REPAIRS.



SMART CAREGIVER CORPORATION
 1229 North McDowell Blvd., Petaluma, CA. 94954 | Tel: 800-650-3637
 sales@smartcaregivercorp.com | www.smartcaregivercorp.com

Bed Pad System

TEST THE SYSTEM

- Plug the pad into the monitor and apply pressure to pad to activate the system. The monitor will beep twice when active.
- The alert will sound when pressure is released from the pad. Press the "reset" on the right hand-side of the monitor to silence the alert.

BED PAD PLACEMENT

- Place the pad under the residents shoulders to be alerted when the resident sits up in the bed (fig 1).
- Place the pad under the resident's lower back/buttocks to be alerted when the resident vacates the bed (fig 2).
- Place the monitor out of reach of the resident. The suitable mounting locations include: the back of headboard, the wall or under the bed. Make sure the resident cannot tamper with the monitor.



Chair Pad System

TEST THE SYSTEM

- Plug the pad into the monitor and apply pressure to pad to activate the system. The monitor will beep twice when active.
- The alert will sound when pressure is released from the pad. Press the "reset" on the right hand-side of the monitor to silence the alert.

WHEELCHAIR/CHAIR PAD PLACEMENT

- Center the pad on the chair seat.
- Place the monitor out of reach of the resident. The suitable mounting locations include: the back or handle of the wheelchair. Make sure the resident cannot tamper with the monitor.

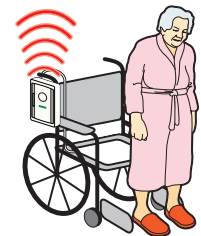
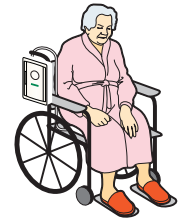

Troubleshooting

- Check the power supply. If you are using battery power, install a new 9V battery. Or, if you are using an AC adapter, make sure the adapter is plugged into a power outlet.
- Make sure that the sensor pad is plugged into the fall monitor.
- Check monitor switches:
 - Check that the volume switch in the battery compartment is set correctly
 - Check that the alert delay switch is set correctly.
- If the steps above do not resolve your problem, call your distributor to troubleshoot. Make sure both the sensor pad and the fall monitor are with you at the time of the call.

Sensor Pad Maintenance

- When using this sensor pad with foam or gel cushions, test the system to make sure it functions properly.
- To reduce the spread of infection, it is recommended to use a new sensor pad for each patient.
- Clean this sensor pad with disinfectant wipes or anti-bacterial cleaners.
- DO NOT fold or crease this sensor pad.
- DO NOT submerge this sensor pad in any liquid cleaning solution.
- DO NOT expose this sensor pad to high temperature sanitizers. Do not sanitize with an autoclave.

Need Set-up Help? (800) 650-3637

1 Install a 9 Volt Battery

Back View of the Monitor Battery Compartment

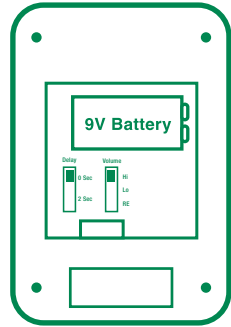

2 Settings

Establish the fall monitor settings with the switches inside the battery compartment.

Alert Delay: Select either 0 Seconds or 2 Seconds.

Alert Volume: Select Hi or Lo alert volume.

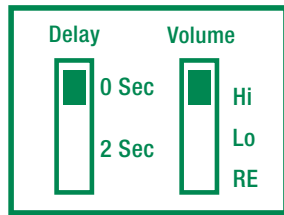

Switches inside the Monitor

CAUTION: The "RE" setting should only be selected when the fall monitor is to be used with a facility's existing Nurse Call Light system. NO AUDIBLE ALERT WILL SOUND FROM THE FALL MONITOR WHEN THE "RE" OPTION IS SELECTED. When this setting is used improperly, it presents a potentially dangerous condition. Therefore, you must consult with your distributor for proper operation.

3 Connect the Pad

Plug the cord end of the sensor pad into the bottom of the fall monitor. Pinch the cord together and route it through the cord protection recess on the fall monitor (near the plug input).

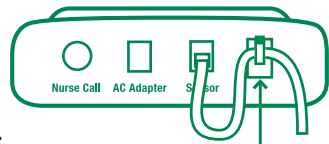

Cord Protection Recess

4 Test the System

Test the system.

(figure A). Place pressure on the sensor pad to activate the pad and the fall monitor. The fall monitor will beep two times to indicate that the sensor pad and the fall monitor are in use.

(figure B). When pressure is removed, the fall monitor will alert. Press the "Reset" button on the side of the fall monitor to silence the alert and reset the system.

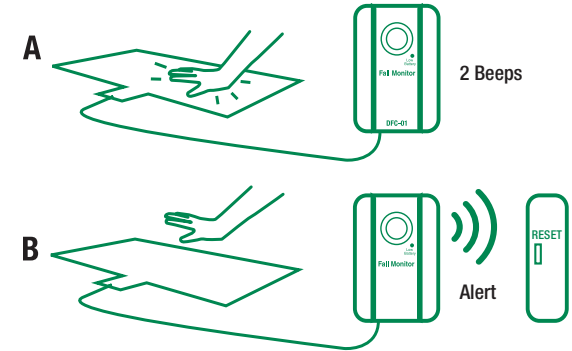

5 Bed Sensor Pad

Position the sensor pad under the resident. Place the sensor pad under the resident's back to be alerted when the resident sits up.

To be alerted when the resident leaves the bed, place the sensor pad under the resident's hips.

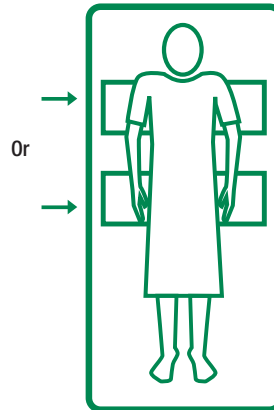

Chair Sensor Pad

Mount the fall monitor on the chair. Suitable locations are back of the wheel chair or on the handle of the wheel chair. Position the sensor pad on the chair under the resident.

